



DRAINAGE SOLUTIONS, INC

(317) 346-4110

www.drainagesolutionsinc.com

REVISIONS			
REV	DESCRIPTION	DATE	APPROVED

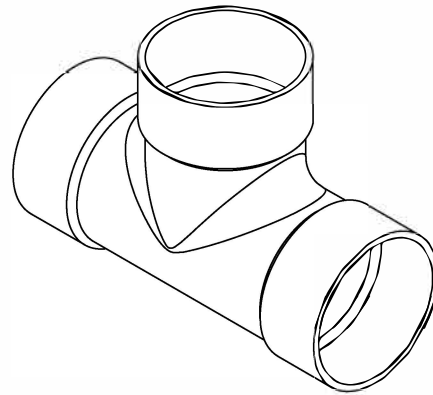
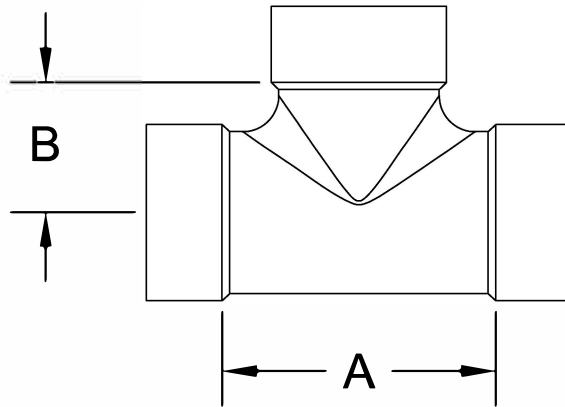

Molded			
Nominal Size	Part Number	A	B
6x6	10100	12.0	6.0

Fabricated			
Nominal Size	Part Number	A	B
8x8	10101	11.5	5.8

Dimensions are approximate due to various factors affecting production. Dimensions are subject to change without notice due to design or production modifications. Unless otherwise specified, socket bottom to socket bottom dimensions are to be +/-1/2". Overall length dimensions are to be +/-1". All fitting angles are to be +/-1 degree. Outside dimensions are to be +/-1/4".

This print discloses subject matter in which Macon Plastics has proprietary rights. This drawing was originated by and is the exclusive property of Macon Plastics. It is furnished for recipient's information only and is not an authorization or license to make this construction or furnish this information to others.



DRAWN BY MF

APPROVED BY JW

Macon Plastics			
<small>P.O. Box 8401 Macon, GA 31208 888.782.2722</small>			
SCH 40 DWV Two-Way Cleanout Tee Hub x Hub x Hub Information			
SIZE A	DWG NO. SDWV-S-TWOWAYTEEHXHXH-10-001	REV	
SCALE NTS	DATE 11/22/2010	SHEET 1 OF 1	