

(317) 346-4110
www.drainagesolutionsinc.com

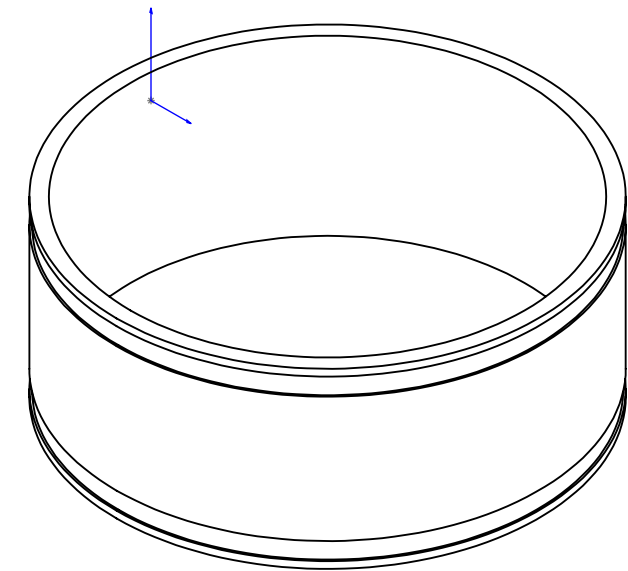

- *Part Includes:
- Clamp: Part Number 248-300, 2 pcs.
 - Shear Ring: Part Number SRC-54, 1 pc.
 - Reducer: Part Number 14.500-12.600R, 1 pc.
 - See additional drawings for these parts.

PROPRIETARY AND CONFIDENTIAL
THE INFORMATION CONTAINED IN THIS
DRAWING IS THE SOLE PROPERTY OF
FERNCO, INC. ANY REPRODUCTION IN
PART OR AS A WHOLE WITHOUT THE
WRITTEN PERMISSION OF FERNCO, INC.
IS PROHIBITED.

Part Weight	13.44 lbs.
Min/Max Temp.	-30/140 Degrees F
Pressure Tested	4.3 PSI
Material	Flexible PVC 60 Duro Shore A
Installation Torque	60" Lbs.
Conforms to ASTM	D5926, C1173
Box Quantity	
Clamps used	300 Series



300 S. DAYTON ST.
DAVISON, MI 48423
PH: 810-653-9626
FAX:810-654-2616

TOLERANCES: .X= Fractional ± .XX= ±.060 .XXX= ±.032 ANG.= ±0.5° UNLESS OTHERWISE SPECIFIED		DESCRIPTION: Coupling 12" Clay x 12" Cast Iron/Plastic	
		1002-1212RC	
UNITS: INCHES	SIZE A	DESIGNER: D. Brady	SCALE not to scale
3RD ANGLE PROJECTION DO NOT SCALE DRAWING		CHECKER:	DATE: 8/15/2008 SHEET 1 OF 1