

\*This Part requires three clamps, part numbers 128-300, 152-300 & 212-300. See additional drawings for information on these parts.

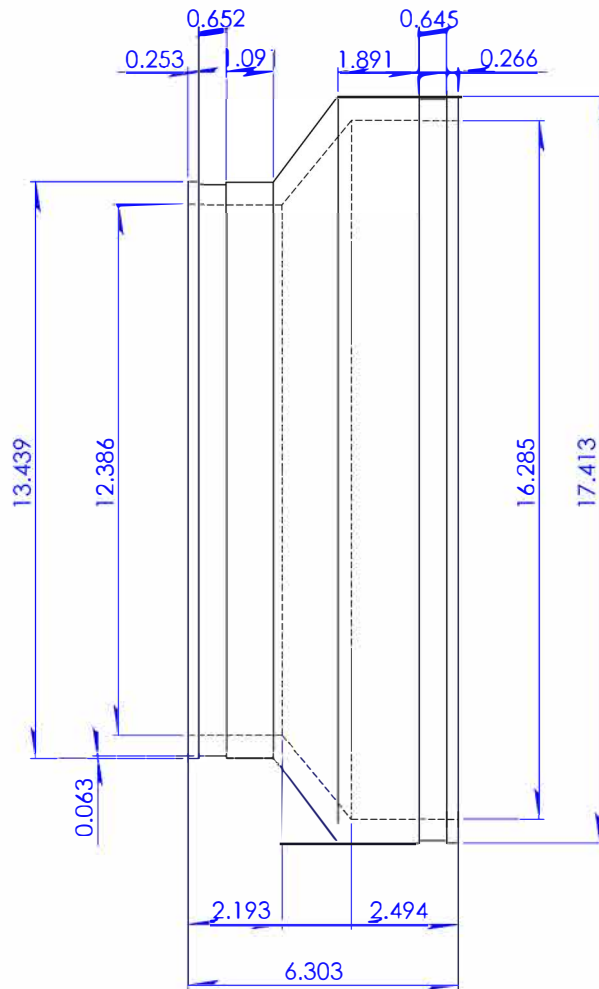

NOTES:  
-SOME HIDDEN LINES NOT SHOWN  
-BREAK ALL SHARP CORNERS  
-REPORT ALL CHANGES TO ENGINEERING

PROPRIETARY AND CONFIDENTIAL  
THE INFORMATION CONTAINED IN THIS DRAWING IS THE SOLE PROPERTY OF FERNCO, INC. ANY REPRODUCTION IN PART OR AS A WHOLE WITHOUT THE WRITTEN PERMISSION OF FERNCO, INC. IS PROHIBITED.

Part Weight	
Min/Max Temp.	-30/140 Degrees F
Pressure Tested	4.3 PSI
Material	Flexible PVC
Installation Torque	60" Lbs.
Conforms to ASTM	D5926
Box Quantity	40
Clamps used	300 Series

**TOLERANCES:**  
.X= Fractional ±  
.XX= ±.02  
.XXX= ±.030  
ANG.= ±0.5°  
UNLESS OTHERWISE SPECIFIED

UNITS:	INCHES
SIZE:	<b>A</b>

3RD ANGLE PROJECTION  
DO NOT SCALE DRAWING

DESCRIPTION:	
Coupling 12" Concrete x 12" Plastic/Cast Iron	
1006-1212	
DESIGNER:	D. Brady
CHECKER:	
DATE:	7/11/2008
SCALE:	not to scale
SHEET 1 OF 1	