

**TOP**

11.6875"sq.

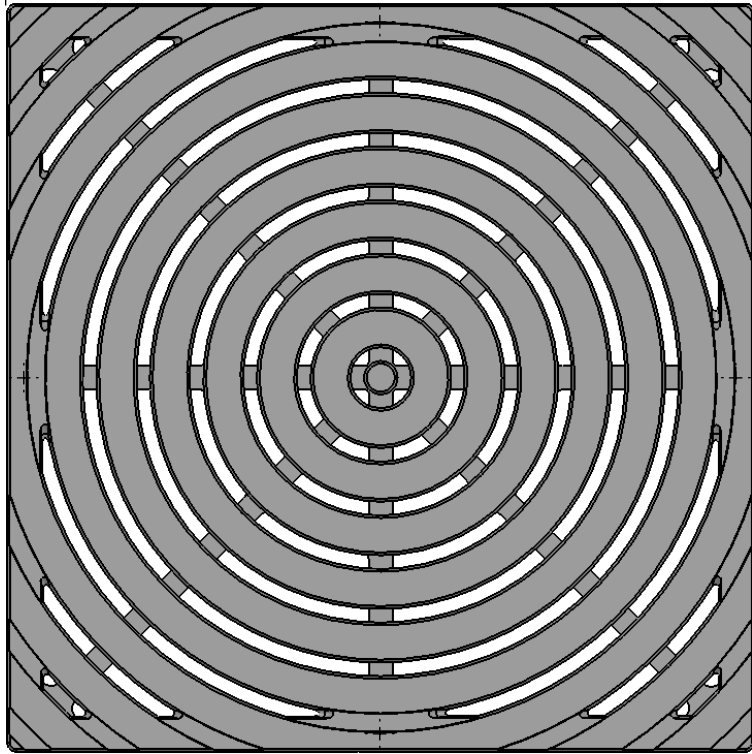

1.125"

**EDGE**

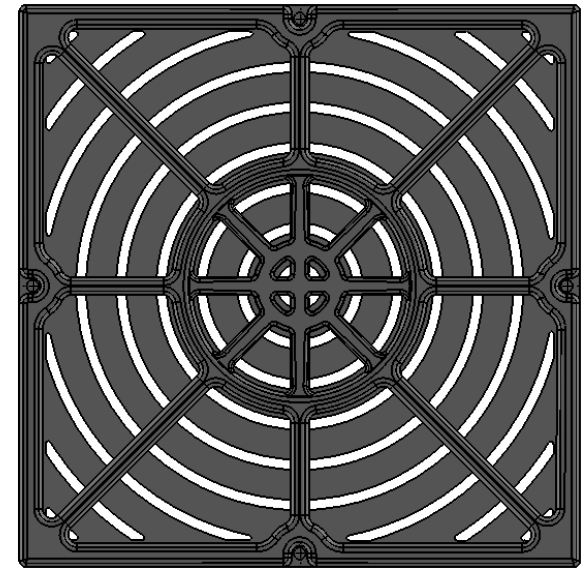
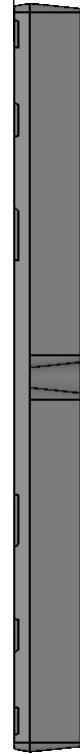

**BACK**

**PERSPECTIVE**

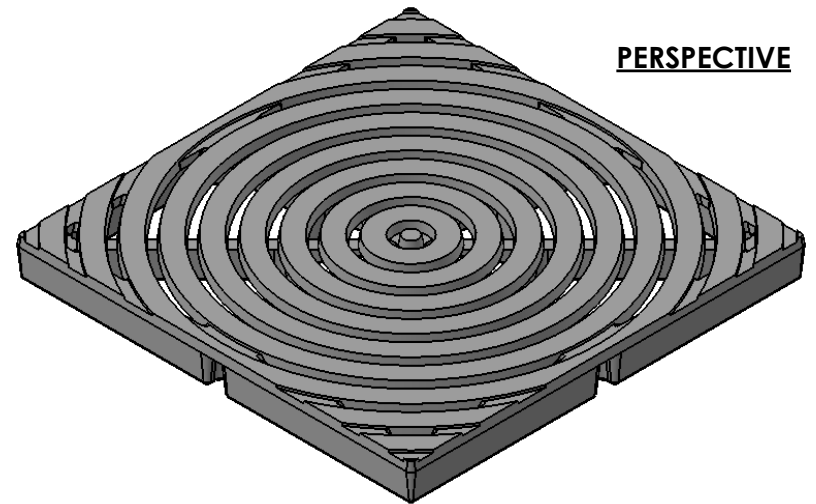

**SIDE**



**NOTES:**

1. Material: cast ductile iron
2. Finish: **Natural**
3. Edge thickness: 1.125"
4. Fits NDS 1200 Series Catch Basin
5. Heelproof; No openings larger than 1/4"
6. Weight approx. 15 lbs
7. Due to casting inconsistencies all dimensions are nominal



(317) 346-4110  
[www.drainagesolutionsinc.com](http://www.drainagesolutionsinc.com)

**Bullseye 12"x12" Catch Basin Grate**

JOB NO. ...  
 DWG. NO. 0BL.I.12x12\_Bullseye  
 Drawn by: JH  
 Date: 1/20/15  
 Scale: NTS