

Part # D1928, 4" x 6" x 6" DWV FLUSHMOUNT DOWNSPOUT ADAPTER

1 1/2" through 12"* injection molded solvent weld Drain, Waste, and Vent (DWV) fittings shall be manufactured in accordance with ASTM D2665, F1866, F2135, and CSA B181.2, as applicable. Injection molded solvent weld DWV fittings shall be certified by the National Sanitation Foundation (NSF) to meet ASTM D2665 and ASTM F2135, as applicable; and by the Canadian Standards Association (CSA) to meet CSA B181.2 as applicable. They shall be certified by the International Association of Plumbing and

[+ more](#)

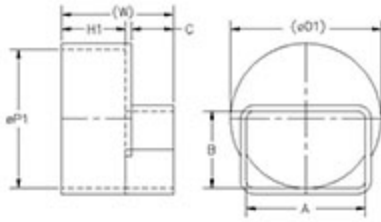

[Specifications](#) | [Dimensions](#) | [Applications](#) | [Certification](#) | [Packaging Information](#)

Specifications

Trade Size	4" x 6" x 6"
Configuration	DOWNSPOUT x H
Construction	Molded fitting
Material	PVC
Color	White

Dimensions

W	5.29 in
H1 Minimum	3.00 in
A	5.69 in
B	3.69 in
C	2.00 in
P1 Nominal Pipe Diameter	6.63 in

Applications

The most complex

Applications

installations require the most advanced fittings. Injection molded DWV fittings from Westlake Pipe & Fittings eliminate typical problems resulting from installing a DWV system with inconsistent, inaccurate, or non-certified fittings. When installing or specifying DWV you can count on a 45° bend being exactly that, a 45° bend. Literally from every angle, Westlake understands the importance of accuracy and consistency on the job site and provides you with a perfect fit from roof to grade. Our DWV fittings make installation of the system quicker, easier and less costly. Productivity gains are significant when our DWV fittings are specified and installed. Combine with our fabricated fittings to ensure a trouble-free installation.

Certification**Certification**

Westlake's PVC Solvent Weld DWV Molded Fittings are third party tested and listed by NSF, UPC, and CSA to meet specifications defined in ASTM D2665, F1866, and CSA B181.2, where applicable. Fabricated fittings conform to ASTM F1866.

Packaging Information

Unit Wt.	1.908 lb
Qty/Box	4
Box LxWxH	17.625 x 13.625 x 12 in
Full Box Wt.	7.632 lb