

Trusted. Tested. Tough.™

Product information presented here reflects conditions at time of publication. Consult factory regarding discrepancies or inconsistencies.

U.S. Patent No.
8,562,287



FM3036
0218
Supersedes
0817

MAIL TO: P.O. BOX 16347 • Louisville, KY 40256-0347
SHIP TO: 3649 Cane Run Road • Louisville, KY 40211-1961
TEL: (502) 778-2731 • 1 (800) 928-PUMP • **FAX:** (502) 774-3624

Visit our web site:
zoellerpumps.com

INSTALLATION INSTRUCTIONS FOR P/N 154923 RUN CAPACITOR ASSEMBLY (FOR MODELS 803/805/807)

IMPORTANT NOTICE:

If your run capacitor is being replaced with a metal case run capacitor, insulated terminals must be installed on the power cord flag terminals. See illustration below.

Assembly directions for run capacitor assembly 154923:

Remove the screws holding the start capacitor bracket. Slide in place the longer end of the run capacitor bracket underneath the correlating start capacitor bracket end. Use the existing screws to secure the start capacitor bracket and the long end of the run capacitor bracket. Use the supplied screw to secure the opposite end of the run capacitor bracket. See illustration below. Reference FM2903 (Installation & Service Instructions) for wiring diagram.

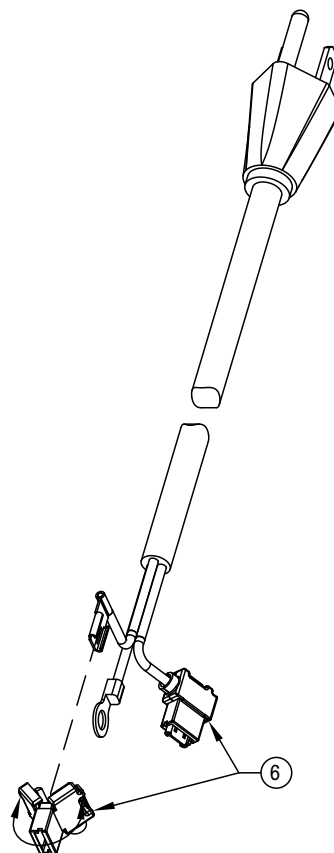
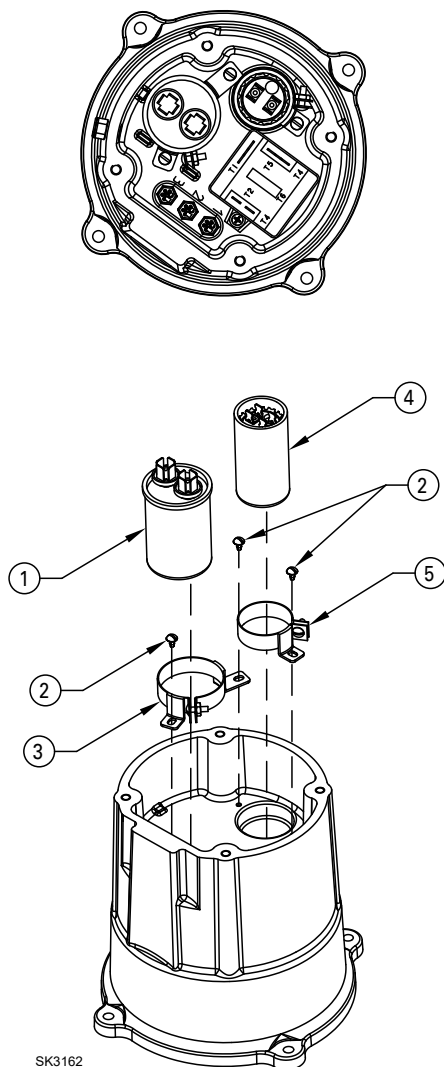

ITEM NO.	DESCRIPTION
1	Run Capacitor, 20 MFD
2	Screw, #6-32 x .25 RHM
3	Run Capacitor Clamp - 1.75" dia.
4	Start Capacitor, 43-52 MFD
5	Start Capacitor Clamp - 1.438" dia.
6	Flag Terminal Insulator



**DRAINAGE
SOLUTIONS, INC**

(317) 346-4110

www.drainagesolutionsinc.com

SK3162